

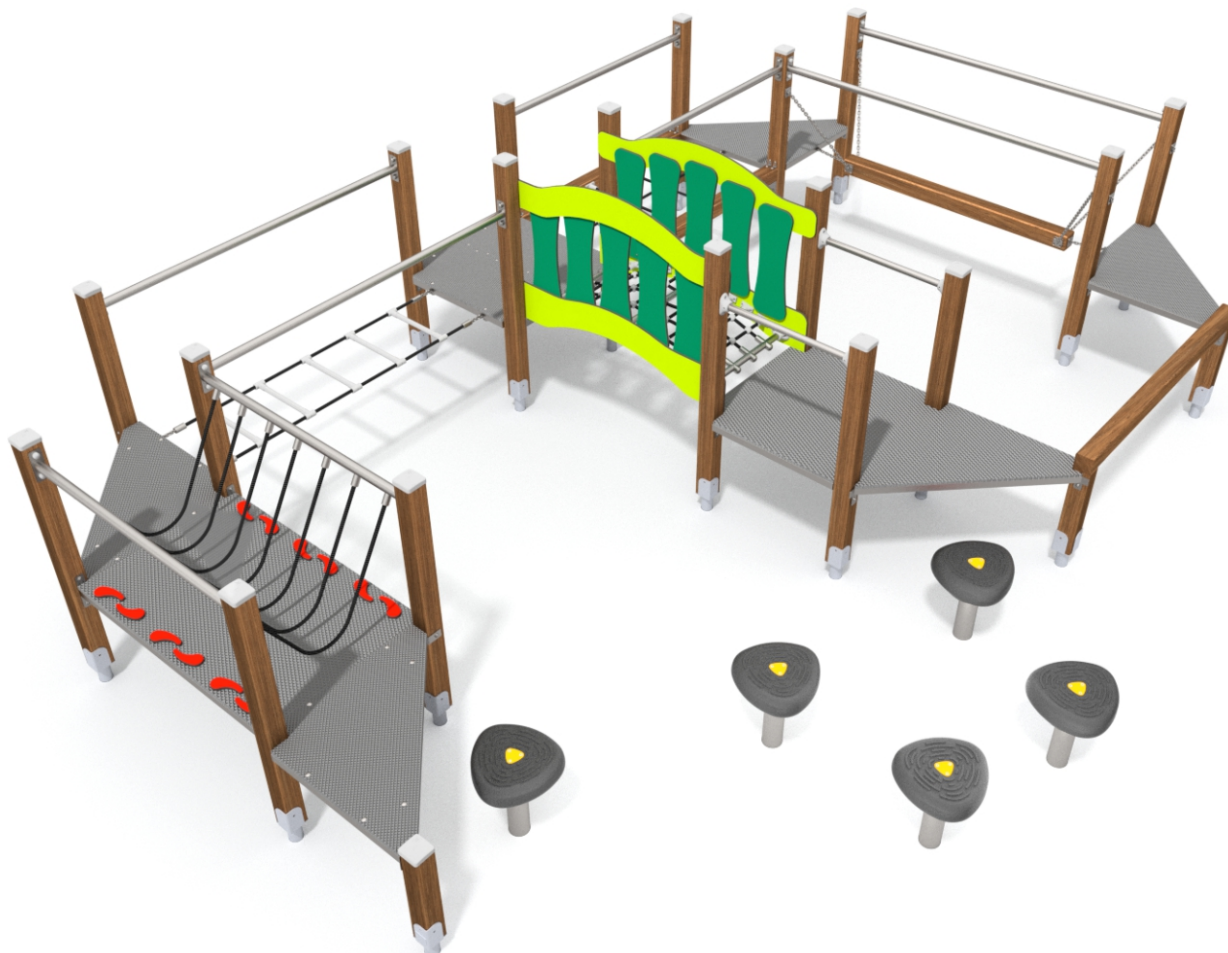

SOCIALIZING



BALANCING



INFORMATION ABOUT THE PRODUCT

Dimensions	453 x 600 cm
Safety zone	753 x 900 cm
Safety zone area	57 m ²
Overall height	155 cm
Free fall height	79 cm
Amount of users	25
Product complies with EN 1176-1:2017-12	YES
Availability of spare parts	YES
Age range	3-12
<small>According to EN 1176-1:2017-12 norm, the product requires applying a safety surface according to the product's free fall height.</small>	

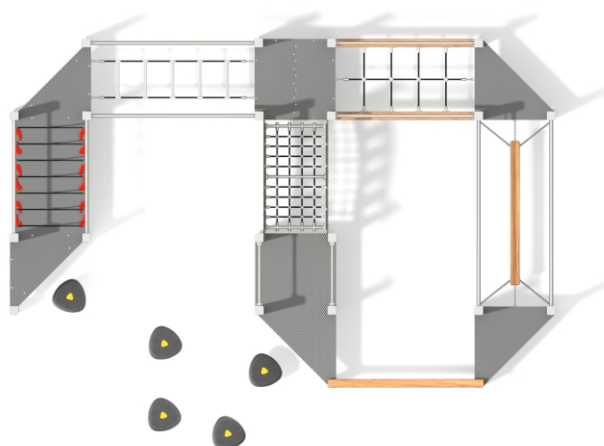

8914

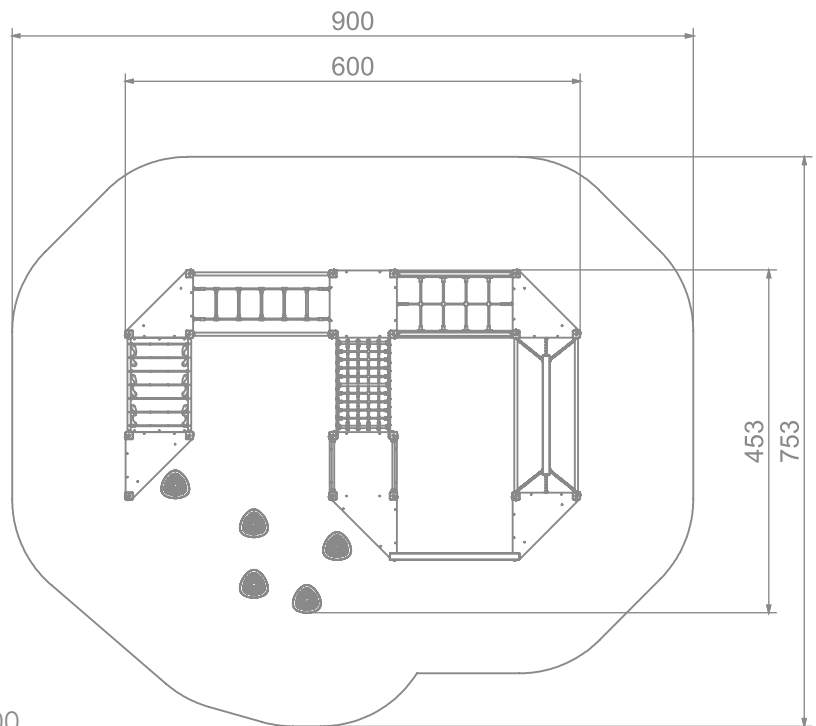
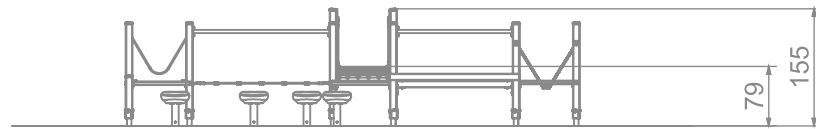

SCALE 1:100

MATERIALS:

<p>ANTI-SLIP ANTHRACITE 10MM HPL PLATFORM PLATE WITH A VERY HIGH RESISTANCE TO WEATHER CONDITIONS AND ATRITION.</p>	<p>POLYPROPYLENE ROPES PP-MULTISPLIT TYPE WITH A STEEL CORE AND A DIAMETER OF 16 MM.</p>	<p>MODULES MANUFACTURED OF ROTOMOULDED POLYETHYLENE DEVELOP</p>
		
<p>SOFT CONIFER WOOD 90 X 90 MM, CORELESS, GLUED IN LAYERS WITH POLYURETHANE GLUES, TOTALLY RESISTANT TO WATER.</p>	<p>WOODEN POSTS ANCHORED TO THE GROUND WITH POWDER GALVANIZED AND POWDER COATED STEEL ANCHORS.</p>	<p>CONNECTING ELEMENTS LIKE SCREWS, NUTS, WASHERS MADE OF STAINLESS STEEL.</p>
		

