

SOCIALIZING



CLIMBING



BALANCING



SLIDING

INFORMATION ABOUT THE PRODUCT

Dimensions	1041 x 619 cm
Safety zone	1424 x 986 cm
Safety zone area	109 m ²
Overall height	409 cm
Free fall height	200 cm
Amount of users	18
Product complies with EN 1176-1:2017-12	YES
Availability of spare parts	YES
Age range	3-12
According to EN 1176-1:2017-12 norm, the product requires applying a safety surface according to the product's free fall height.	

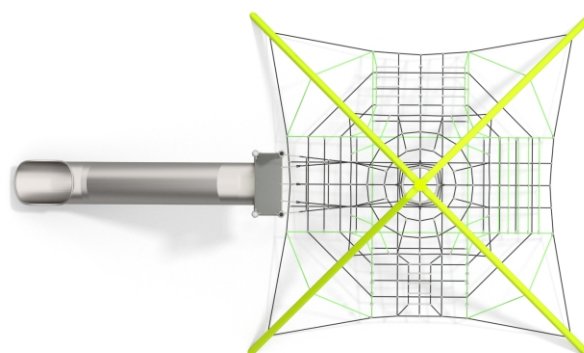

9128

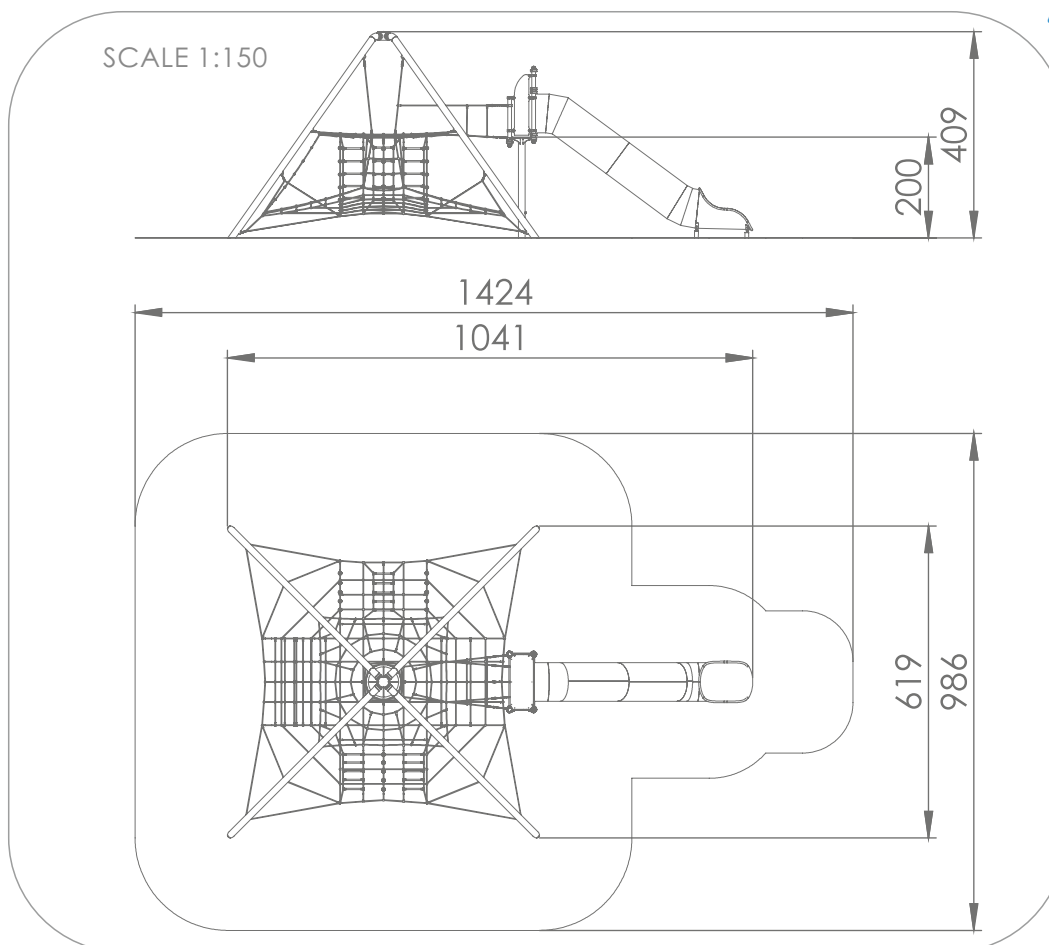

MATERIALS:

PLATES OF THE WALLS MADE OF COLOURFUL TRIPLE LAYERED 15 MM HDPE



ANTI-SLIP 13 MM HPL PLATFORM PLATE

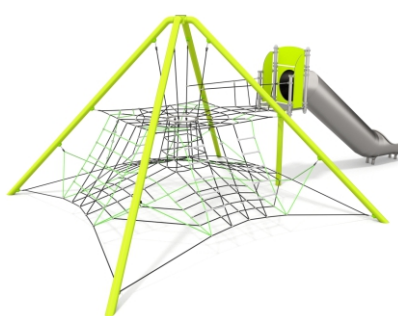

INNOVATIVE SYSTEM OF CONNECTORS OF STAINLESS STEEL CHAINS WITH POSTS



ROPE ENDINGS PRESSED IN A SLEEVE MADE OF DURABLE ALUMINUM ALLOY

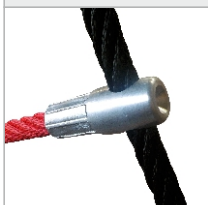

SOLID CONSTRUCTION MADE OF BLACKSTEEL S235JR, CLEANED IN THE SANDBLASTING PROCESS



ATTENDED 6 MM STAINLESS STEEL CHAINS

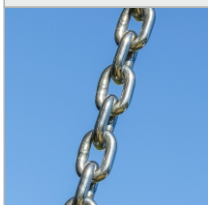

TUBE SLIDE MADE OF STAINLESS STEEL AISI 304



VANDAL-PROOF SCREW PLUGS MADE OF INJECTION MOLDED POLYAMIDE

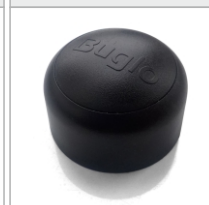

CONNECTING ELEMENTS LIKE SCREWS, NUTS, WASHERS MADE OF STAINLESS STEEL

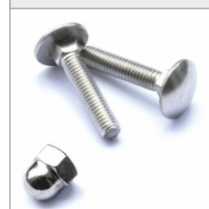

ROPE LADDER STEPS AND ROPE KNOTS MADE OF INJECTION MOLDED POLYAMIDE



POLYPROPYLENE ROPES PP - MULTISPLIT TYPE WITH A STEEL CORE AND A DIAMETER OF 16 MM



POST ENDINGS FINISHED WITH SOFT EPDM RUBBER



SOLID CONSTRUCTION MADE OF STAINLESS STEEL AISI 304



PATENTED SYSTEM OF CONNECTORS AND CLAMPS MADE OF STRONG ALUMINUM ALLOY

